



**IP-COM**  
World Wide Wireless

# Pro-6-IW

AX3000 Wi-Fi 6 Wireless In-Wall Access Point

# Pro-6-IW

## AX3000 Wi-Fi 6 Wireless In-Wall Access Point

---

### Product Description

Pro-6-IW is a Gigabit dual-band panel AP based on the new Wi-Fi 6 standard. It realizes a bandwidth of 160 MHz and a wireless rate of 3000 Mbps, which is twice that of ordinary Wi-Fi6 products. The fast roaming feature enables the AP to automatically select a better quality wireless network. With just one Ethernet cable, you can enjoy both wireless and wired networks. Pro-6-IW is a wise choice for you to deploy high-performance WLAN network for the double-sided tape installation method it added.



## Key Features

- \* Support k/v/r fast roaming
- \* Support IPTV penetration
- \* Traffic control function
- \* Double-sided tape installation
- \* 3000 Mbps Wireless rate
- \* Support Mesh technology

## Product Features



### Support k/v/r fast roaming, seamless Wi-Fi switching

Support roaming agreement, the AP automatically discovers and switches wireless networks with better quality, making network switching smoother.



### IPTV penetration supported, strong anti-interference capability

The AP supports IPTV and provides a wired Ethernet port that is isolated from the wireless network. With one Ethernet cable, users can enjoy wireless network and network TV at the same time, eliminating the worry of purchasing IPTV services and network services together.



### 3 Gbps high-speed Wi-Fi, 2.5 times higher rate

Both the 2.4 GHz and the 5 GHz radio bands support the new Wi-Fi 6 standard. Applying higher-standard hardware equipment, the concurrent Wi-Fi rate is as high as 3 Gbps, 2.5 times that of the last-generation of AP (AC1200).



### Mesh technology supported, rapid deployment and installation

Pro-6-IW automatically detects peripheral devices and rapidly forms a network when powered on, and completes the deployment and installation of multiple devices in 2 minutes without smashing walls for wiring.

## Product Features

---



### Double-sided tape installation, saving time and effort

With the double-sided tape on the back of the AP, users can directly stick it on the wall with a cassette, avoiding the use of screwdrivers and damage to the wall.



### Traffic control to improve user online experience

By controlling the uplink and downlink rates, Pro-6-IW avoids the slow network speed of wireless clients when uploading or downloading large files, balances the network speed and improves the user experience.

# Application Scenarios

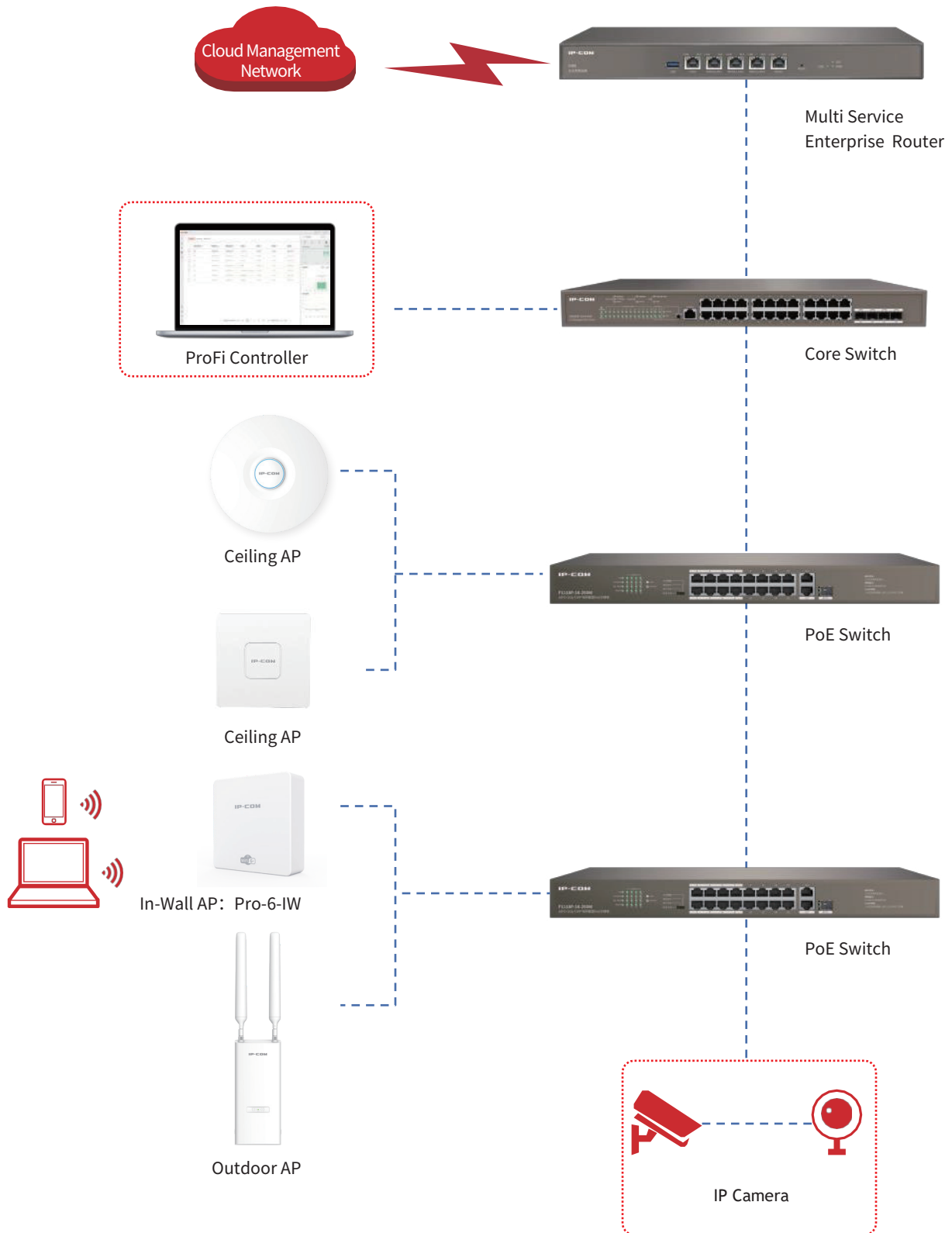

# Specifications

Product Information	
Model	Pro-6-IW
Category	In Wall
Dimensions	86*86*32 mm
Hardware Specifications	
Frequency band	2.4 GHz, 5GHz
Wireless Standards	IEEE 802.11a/b/g/n/ac/ax
2.4 GHz Data Rate	1-574 Mbps
5 GHz Data Rate	6-2402 Mbps
Channel Width	20 MHz/ 40 MHz / 80 MHz / 160MHz
MU-MIMO	2X2 MU-MIMO
Ethernet Port	One 10/100/1000 Mbps LAN Port (PoE) One 10/100/1000 Mbps LAN Port
Button	1* Reset
LED Indicator	Bi-Color LEDs
Max Power Consumption	8.5W
Power Supply Standard	IEEE 802.3af PoE, DC 12V 1A
Connected Clients	256
2.4 GHz Antenna Gain	4 dBi
5 GHz Antenna Gain	5 dBi
Transmission Power	CE: <20 dBm (2.4 GHz, EIRP) <23 dBm (5 GHz, EIRP) FOC: <26 dBm(2.4GHz) <26 dBm (5 GHz) 21.5+/1.5dBm 23.5+/1.5dBm
2.4 GHz 802.11b RX Sensitivity	-95.5 dBm
2.4 GHz 802.11n (MCS7) RX Sensitivity	-72.5 dBm
5 GHz 802.11a RX Sensitivity	-97.5 dBm
5 GHz 802.11n (MCS7) RX Sensitivity	-77.5 dBm

# Specifications

## Software Specifications

Operating mode	AP, Client+AP
Hide SSID	Supported
Max. No. of SSID	2.4 GHz: 8 5 GHz: 8
OFDMA	Supported
Beamforming	Supported
TWT	Supported
802.11k/v/r	Supported
WEP	Supported
WPA-PSK	AES/TKIP
WPA2-PSK	AES/TKIP
WPA3-SAE	AES
WPA	Supported
WPA2	Supported
Access control	MAC address-based
Adjustable power transmit	Supported
Frequency analysis	Supported
AP isolation	Supported
Connected clients control	Supported
Weak Signal Client Limitation	Supported
Prefer 5 GHz	Supported
WMM	Supported
VLAN tagging for SSID	Supported
LED indicator control	Supported
Diagnostics tool	Ping
Scheduled reboot	Supported
Reboot at specified interval	Supported

# Specifications

## Software Specifications

Device management	Web management, controller management, cloud platform management, APP management
System logs	Supported
Firmware Upgrade	Local and AC upgrade
Reboot	Local and AC reboot
Reset	Local and AC reset
Backup configuration	Supported
Restore configuration	Supported

## Operating Environment

Default login IP address	192.168.0.254
Default user name	admin
Default password	admin
Operating temperature	-10°C - 40°C
Operating humidity	(10% - 90%) RH, non-condensing
Storage temperature	-30°C - 70°C
Storage humidity	(5% - 90%) RH, non-condensing

**IP-COM**  
World Wide Wireless

### IP-COM NETWORKS CO., LTD.

Tower E3, No.1001, Zhongshanyuan Road,  
Nanshan District, Shenzhen, China. 518052  
Service: [info@ip-com.com.cn](mailto:info@ip-com.com.cn)  
Inquiry: [marketing@ip-com.com.cn](mailto:marketing@ip-com.com.cn)  
Tel: +86-755-27653089