

STING

Electromechanical automation for swing gates
up to 3m - 400 kg



For residential and
collective usage



Available in 230V and 24V



#fastasyoulike!
STING/BOOST
gate opening at 90° in 9"



STING

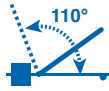

Door opening up to 110°.

Robust and reliable operator, in an enclosed body



Quick unlocking with customised metal key



Get rid of ground stops by using the mechanical stops (optional)

New colour

Reversible version
art. STING/24/R



STING BLACK

STING DARK GREY

No risk of the gate operation stopping in a power outage thanks to the backup batteries (optional, art. BAT, code 629290) that can be installed on 24V models



Greater installation versatility thanks to the adjustable fixing plates excluded (art. MLS/SFR)



STING	Opening time about 90°	16"
STING/BOOST		9"
STING/24/R		12"

Note: the opening time may increase depending on the characteristics of the installation







Fast maneuvering with STING/BOOST: the 24V model of the STING range with a minimum opening time of 90° in 9 seconds. Available in kit.



Models

230V ~ operators without control board









COD.	Art.				OTHER CHARACTERISTICS
625050	STING		395mm without MAC/FM 334mm with MAC/FM		• For leaves up to 3m length
625052	STING/EN		395mm without MAC/FM 334mm with MAC/FM	✓	• With encoder, for leaves up to 3m
NEW 625058	STING/EN-BLACK		395mm without MAC/FM 334mm with MAC/FM		• For leaves up to 3m length

All models have: adjustable fixing plates to be screwed included (art. MLS/SFR)

Control board to complete the installation: control board cod. 677610 art. NET230N/C (with box)

24V = operators without control board



COD.	Art.			OTHER CHARACTERISTICS
625051	STING/24		395mm without MAC/FM 334mm with MAC/FM	• For leaves up to 3m length
NEW 625059	STING/24-BLACK		395mm without MAC/FM 334mm with MAC/FM	• For leaves up to 3m length
625056	STING/24-BOOST (37 mm/s)		395mm without MAC/FM 334mm with MAC/FM	• For leaves up to 3m length
NEW 625060	STING/24/R *		395mm without MAC/FM 334mm with MAC/FM	• For leaves up to 3,5m length / 300kg • Reversible

All models have: adjustable fixing plates to be screwed included (art. MLS/SFR)

Control board to complete the installation: control board cod. 678261 art. NET24N/C (with box)

*Supplied with: adjustable brackets, 1pc Omron socket and 1pc monostable relay

Technical info

TECHNICAL INFO	STING	STING/EN	STING/24	STING/24-BOOST	STING/24/R
Motor power supply (V)	230V ~ ± 10 % (50/60 Hz)		24V =		24V =
Maximum power absorption (W)	300		60	85	60
Max thrust (N)	1650		1000	1000	1000
Time with total stroke (s)	21		22	9	34
90° Opening time (s)*		16		9	11,6
Duty cycle (cycles/hours)	18	22		40	
N. max cycles in 24h.			90		300
Built-in capacitor (µF)	8			/	/
Operating temperature (°C)			(-20°) - (50°)		
Motor thermal protection (°C)	150			/	/
Weight with packing (Kg)			8,8		
Sound pressure (dBA)			< 70		
Protection rating			IPX4		

*the opening time of the leaf at 90° may be different according to the characteristics of the installation

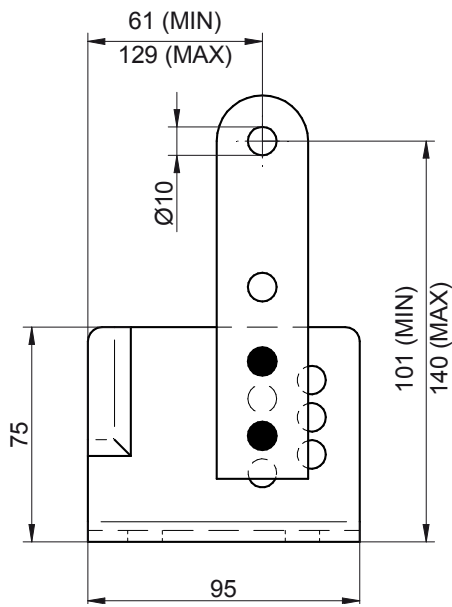
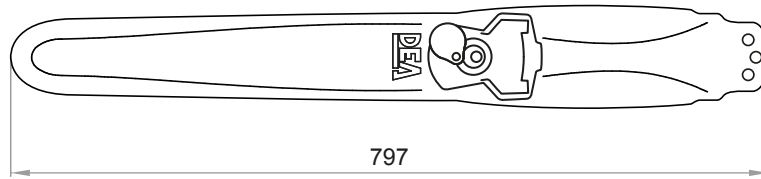
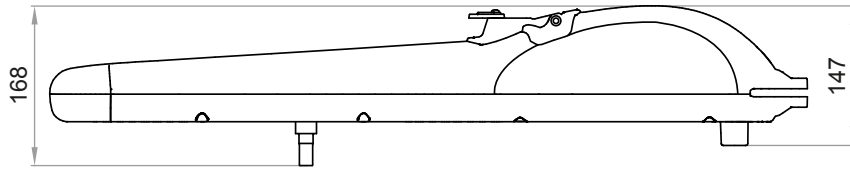

rear

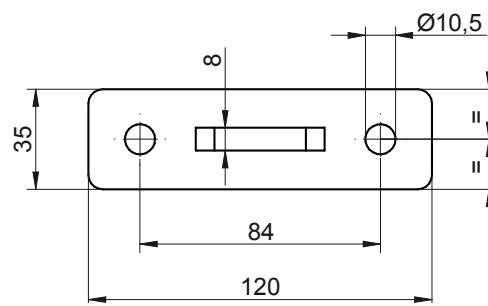
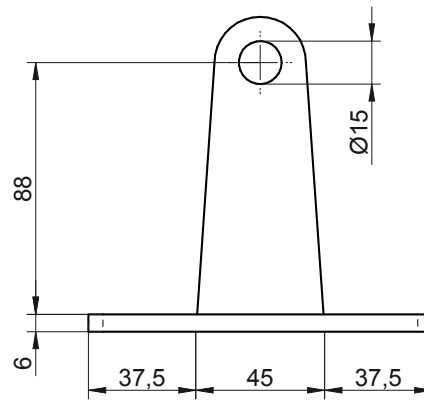

front

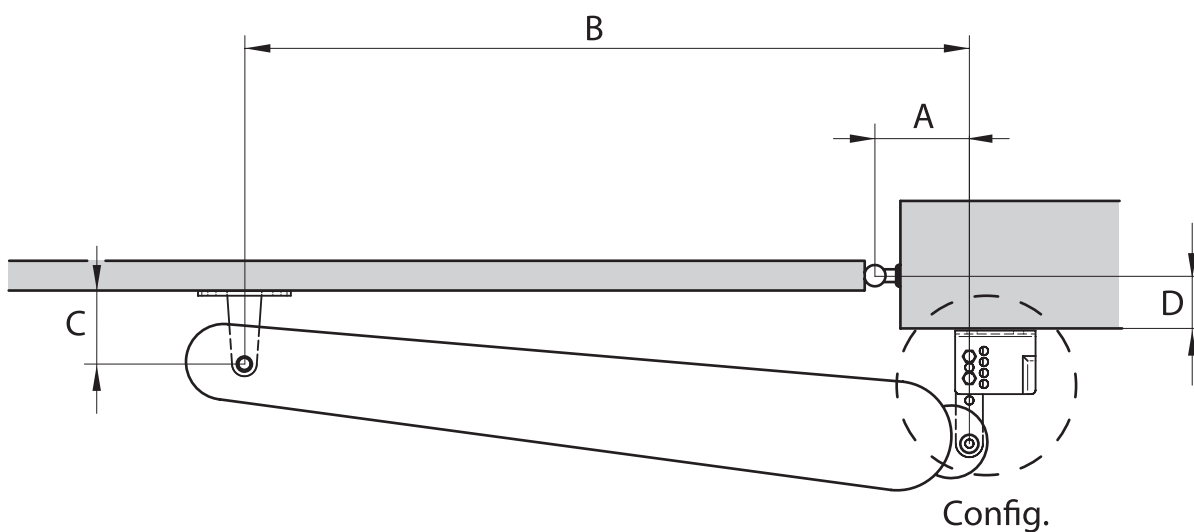

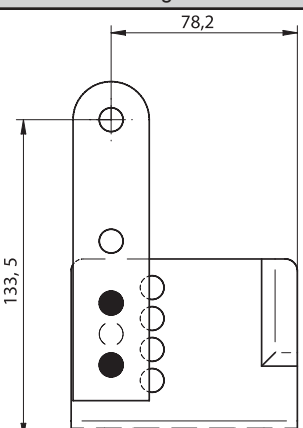
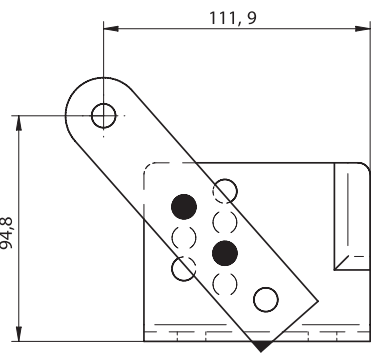
Art. STING	
Config. 1	Config. 2
	

STING + Art. MAC_FM						
	Config.	A	B	C	D	Note
90°	1	125	685	94	0÷50	* Senza fermi meccanici in apertura (corsa max 367 mm), Without mechanical stops in opening (max stroke 367 mm), Sans arrêts mécaniques en ouverture (course maxi 367 mm), Ohne mechanische Anschläge an Öffnung (max Hub 367 mm), Sin finales de carrera mecánicas en abertura (recorrido max 367 mm), Sem fins de cursos mecânicos no abertura (curso Max. 367mm), Bez ograniczników mechanicznych na otwarcie (max wysuw 367 mm), Без механических упоров на открытие (ход штока макс 367 мм).
	2	125	685	94	50÷75	
	2	140	685	109	75÷100*	
	2	140	685	114	100÷125*	
100°	1	160	690	104	0÷25*	

STING						
	Config.	A	B	C	D	Note
90°	1	125	720	94	0÷50	
	2	125	715	94	50÷100	
	2	150	715	124	100÷125	
100°	1	160	720	104	0÷25	
	1	170	720	109	25÷50	
110°	1	185	720	99	0	
	2	185	720	99	25	